

THESE DRAWINGS AND SPECIFICATIONS ARE THE PROPERTY OF JBL. INCORPORATED THEY ARE ISSUED IN STRICT CONFIDENCE AND SHALL NOT BE REPRODUCED, COPIED, OR USED AS THE BASIS FOR MANUFACTURING OR SALE OF APPARATUS WITHOUT WRITTEN PERMISSION	
PART NO	DESCRIPTION

THESE DRAWINGS AND SPECIFICATIONS ARE THE PROPERTY OF JBL INCORPORATED. THEY ARE ISSUED IN STRICT CONFIDENCE AND SHALL NOT BE REPRODUCED, COPIED, OR USED AS THE BASIS FOR MANUFACTURING OR SALE OF APPARATUS WITHOUT WRITTEN PERMISSION.

ALL MATERIAL SPECIFIED IN THIS DRAWING SHALL CONFORM TO THE REQUIREMENTS OF THE EUROPEAN DIRECTIVE 2002/95/EC (RoHS)

REVISONS		DESCRIPTION	DRAFT	CHK	DATE	APPR
CHG	LTR					
X1	RELEASE FOR QUOTE		DR			

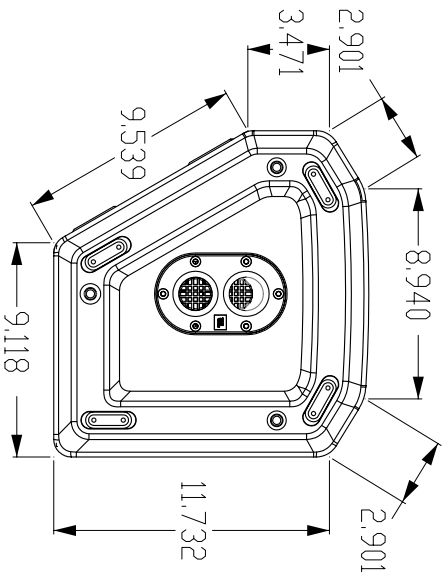
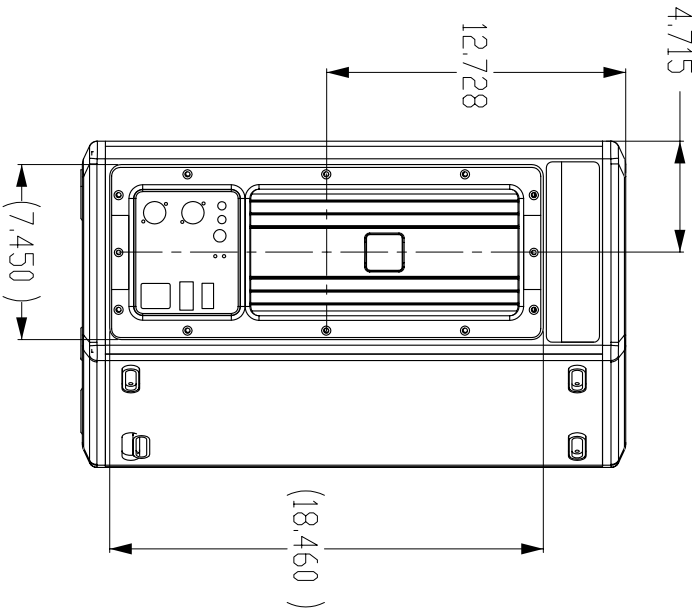
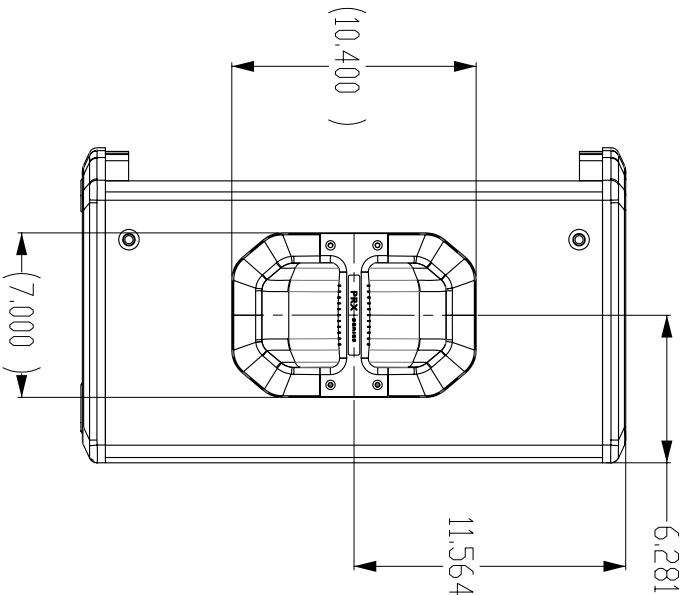
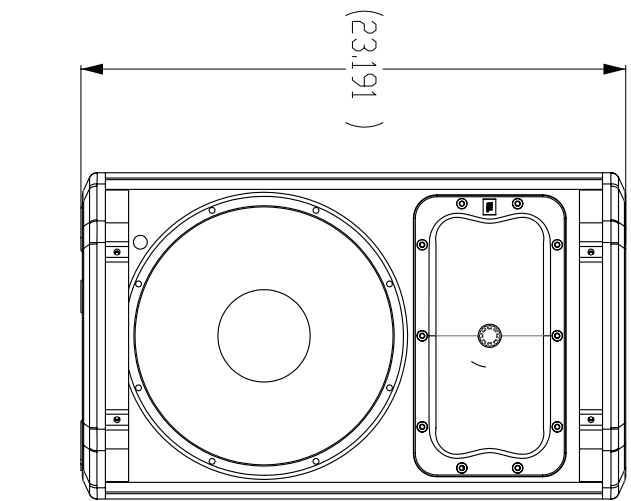
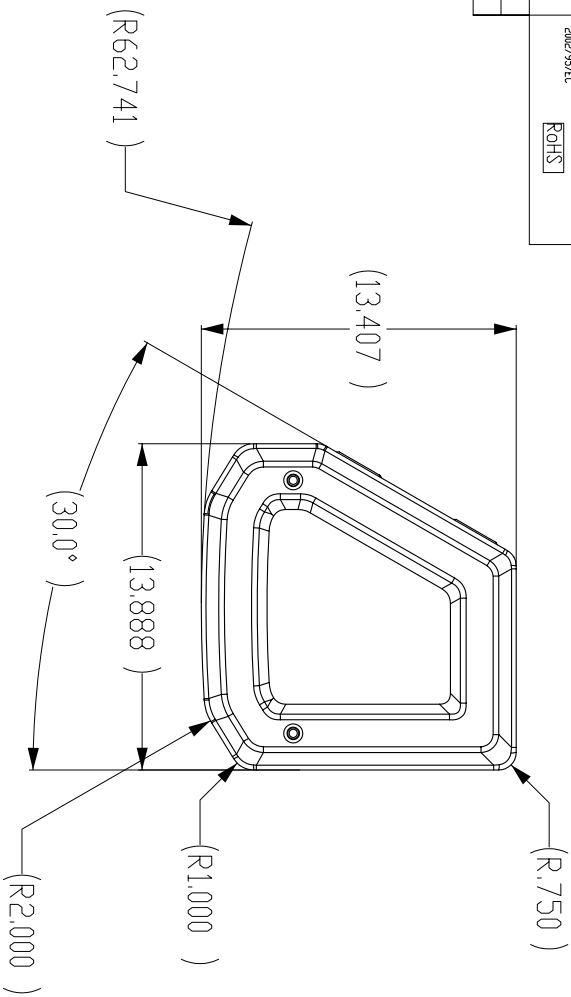

UNCONTROLLED COPY

NOTES: (UNLESS OTHERWISE SPECIFIED)

ITEM	PART NO.	DESCRIPTION	REMARKS/REF. P./N/S
TOLERANCES			
METRIC			
TOLERANCES WILL INFER			
(UNLESS OTHERWISE SPECIFIED)			
XXX ± .005 INCH			
XX ± .001 INCH			
X ± .001 INCH			
ANGULAR ± .030°			
FRACTIONAL ± 1/32			
DIMENSIONS ARE IN INCHES			
BREAK EDGES TO .005 IN			
ALL DIMENSIONS ARE FINISHED DIMENSIONS			
DO NOT SCALE DRAWING			
TOLERANCES ARE IN MILLIMETERS			
TOLERANCES WILL INFER			
(UNLESS OTHERWISE SPECIFIED)			
XXX ± .005 INCH			
XX ± .001 INCH			
X ± .001 INCH			
ANGULAR ± .030°			
FRACTIONAL ± 1/32			
DIMENSIONS ARE IN MILLIMETERS			
BREAK SHARP EDGES TO .01 mm			
ALL DIMENSIONS ARE FINISHED DIMENSIONS			
DO NOT SCALE DRAWING			
DRAWN BY		DATE	
D.A.R.		DATE	
DESIGNER		DATE	
ENDER		DATE	
THIRD ANGLE PROJECTION			
SCALE: 3 / 1			
SHEET 1 OF 2			

JBL Professional
A Harman International Company
Northridge, California 91329, U.S.A.

PRX612M

MARKETING

X1